

**TSI 04/2021**

Crankshaft Oil Seal 394.012

Citroën | Peugeot | Ford | Land Rover | Volvo



DW10 | DW12  
2.0 TDCi | 2.2 TDCi  
D 4204 T | D4204 T2  
224DT



### Citroën | Peugeot

Mandatory use tool 0188-AK1 | 0188-AK2Z  
for professional installation.

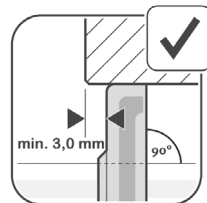
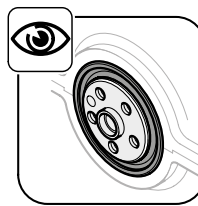
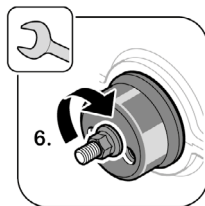
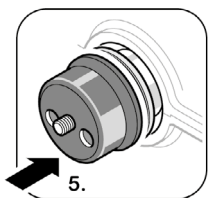
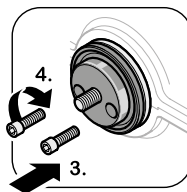
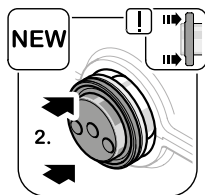
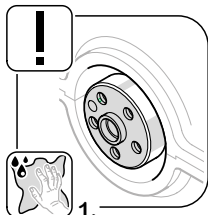

**ElringKlinger AG | Division Aftermarket**

Max-Eyth-Straße 2 | D-72581 Dettingen/Erms

Fon +49 7123 724-799 | Fax +49 7123 724-798

service@elring.de | www.elring.com



**Das Original**

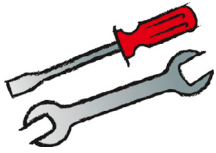

## Ford | Land Rover | Volvo

Mandatory use tool 303-1176 for professional installation.

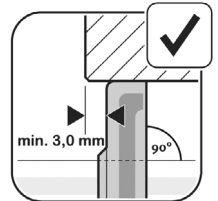
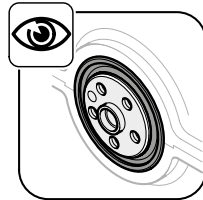
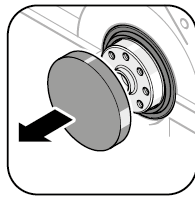
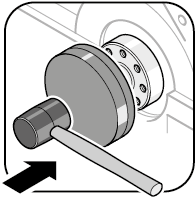
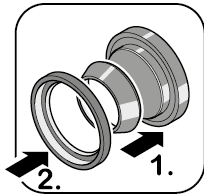

Das Original